

GROUP 80A**CONFIGURATION
DIAGRAMS****CONTENTS**

OVERALL CONFIGURATION DIAGRAM.....	80A-2	DASH PANEL.....	80A-10
HOW TO READ CONFIGURATION DIAGRAMS	80A-3	FLOOR AND ROOF	80A-16
ENGINE COMPARTMENT.....	80A-4	DOOR	80A-18
ENGINE AND TRANSAXLE	80A-6	LUGGAGE COMPARTMENT.....	80A-20

OVERALL CONFIGURATION DIAGRAM

M1801000102189

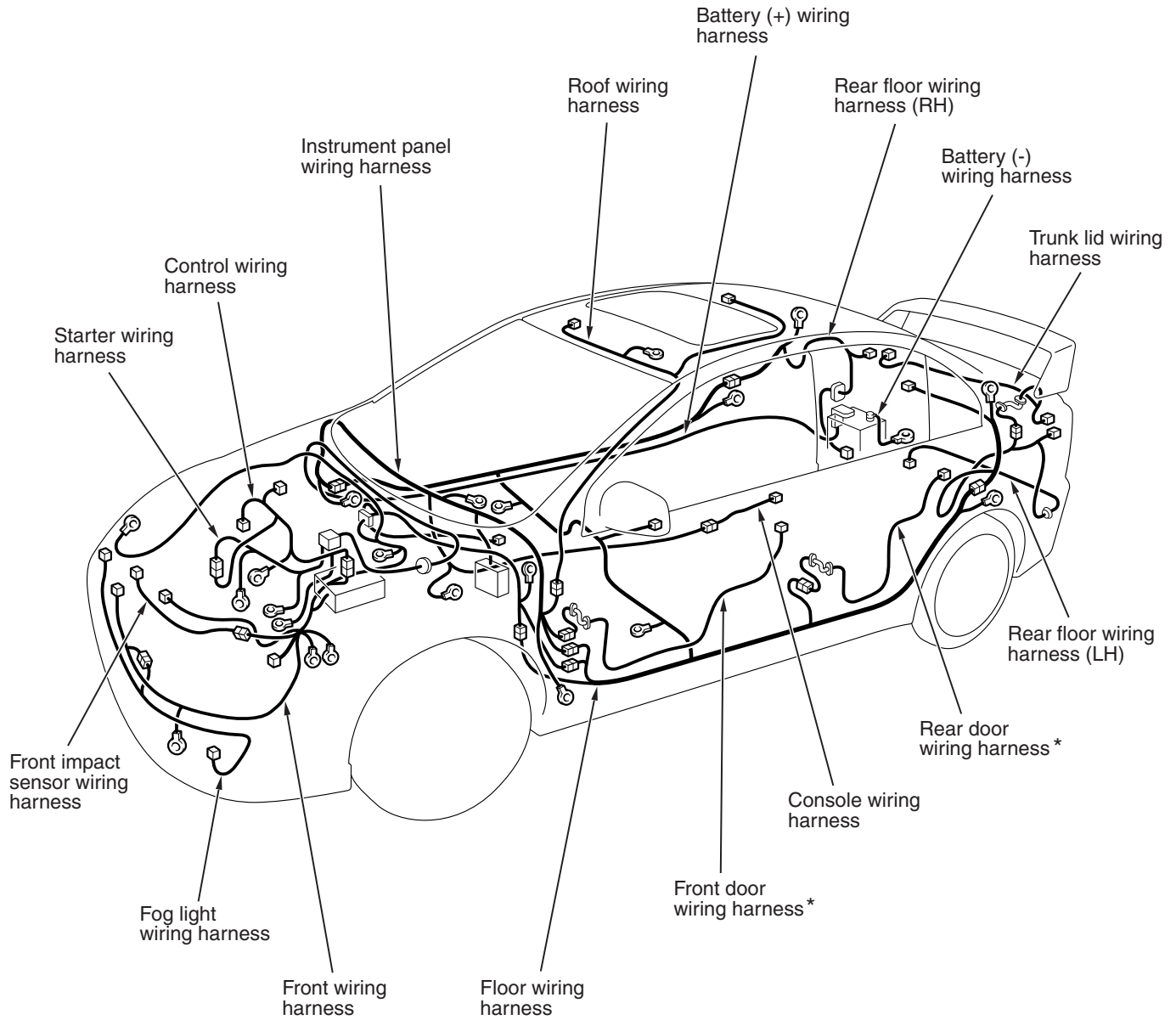

AC708222AB

NOTE:

1. This illustration shows only major wiring harnesses.
2. *: also equipped at the right side.

HOW TO READ CONFIGURATION DIAGRAMS

M1801000200555

The wiring harness diagrams clearly show the connector locations and harness configurations on actual vehicles. Some variations are included in one configuration diagram. Accordingly, some diagrams may not be applicable for individual vehicles.

Denotes connector No.
The same connector No. is used throughout the circuit diagrams to facilitate connector location searches.
The first alphabetical symbol indicates the location site of the connector and a number that follows is the unique number.
Numbers are usually assigned to parts in clockwise order on the diagram.

Example: A-19

Number specific to connector (serial number)

Connector location site symbol

A: ENGINE COMPARTMENT	D: FLOOR AND ROOF
B: ENGINE AND TRANSAXLE	E: DOOR
C: DASH PANEL	F: LUGGAGE COMPARTMENT

Denotes ground point.
Same ground number is used throughout circuit diagrams to facilitate search of ground point.
Refer to GROUP 70 COMPONENT LOCATIONS -GROUND MOUNTING LOCATIONS for details of ground points.

Denotes harness name.

Denotes a section covered by a corrugated tube.

The mark ★ shows the standard mounting position of wiring harness.

Denotes the color of the tube
(If not specified, it is black).
R: Red
Y: Yellow

The number of connector pins and the connector color (except milk white)* are shown for ease of retrieval.

Example: (2-B)

Connector color (milk white if no color is indicated)

Number of connector pins

*: Typical connector colors

B: Black	BR: Brown
Y: Yellow	V: Violet
L: Blue	O: Orange
G: Green	GR: Gray
R: Red	NONE: Milk white

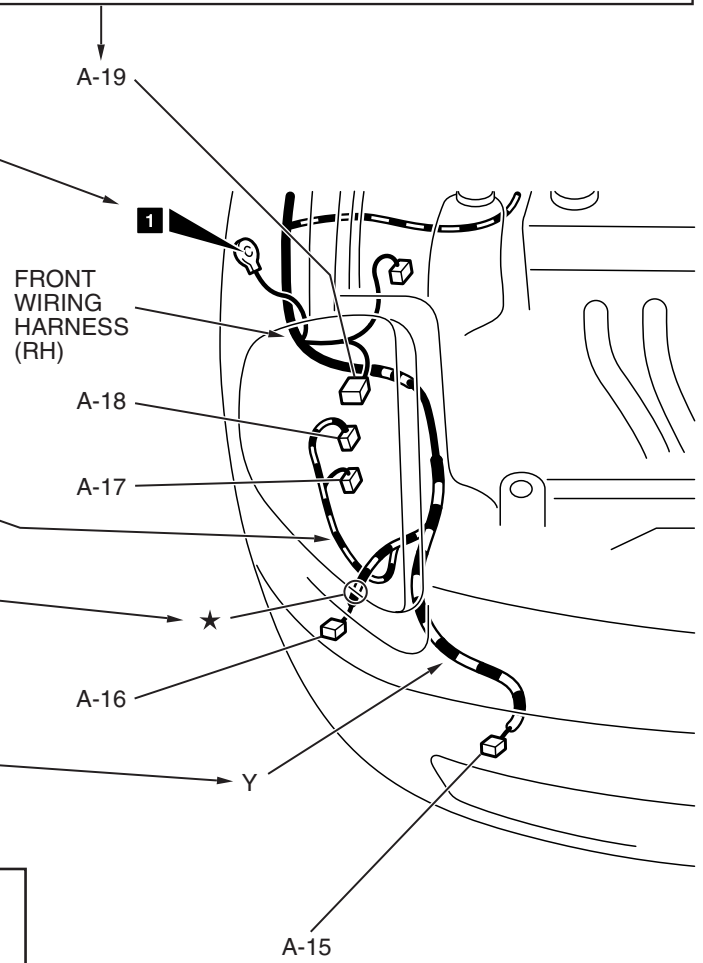

- | | |
|-------------|-------------------------|
| A-15 (2) | FOG LIGHT (RH) |
| A-16 (2-GR) | HORN (LOW) |
| A-17 (2-B) | HEADLIGHT (RH) |
| A-18 (2-B) | WINDSHIELD WASHER MOTOR |
| A-19 (2-GR) | DUAL PRESSURE SWITCH |

Indicates the device to which the connector is connected.

ENGINE COMPARTMENT

M1801000306884

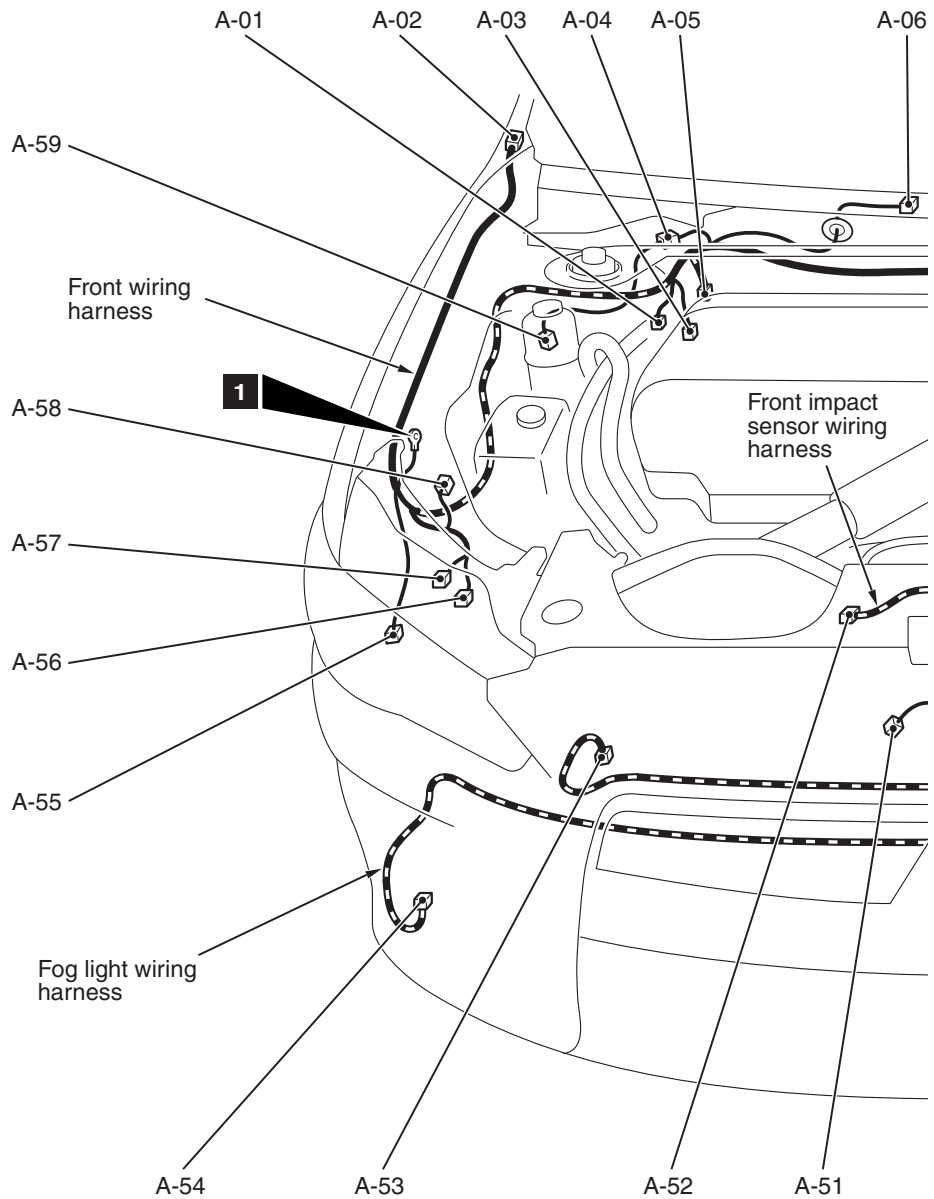
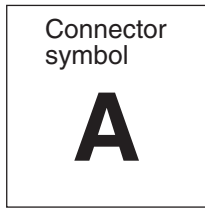

- Connector color code
- B: Black
 - BR: Brown
 - G: Green
 - GR: Gray
 - L: Blue
 - NONE: Milk white
 - O: Orange
 - R: Red
 - V: Violet
 - Y: Yellow

AC901349AB

A-01	(3-GR)	No connection	A-14	(24)	Joint connector (CAN4) <TC-SST>
A-02	(2-B)	Side-turn signal light (RH)	A-15X	(4)	Fog light relay
A-03	(2-B)	Front wheel speed sensor (RH)	A-16X	(4)	Horn relay
A-04	(1-B)	Front wiring harness and theft-alarm horn sub wiring harness combination	A-17X	(4)	A/C compressor clutch relay
A-05	(47-B)	ASC-ECU	A-18X	(4)	Theft-alarm horn relay
A-06	(5-GR)	Windshield wiper motor	A-20X	(4)	No connection
A-07	(4-GR)	Mass airflow sensor	A-21X	(4)	Headlight relay (High)
A-08	(2-B)	Turbocharger wastegate solenoid 2	A-22X	(4)	Throttle actuator control motor relay
A-09	(2)	Brake fluid level switch	A-24X	(4)	Daytime running light relay
A-10	(2-BR)	Turbocharger wastegate solenoid 1	A-25X	(4)	Injector relay
A-11	(2-B)	Front wheel speed sensor (LH)	A-26X	(4)	Electric pump relay
A-12	(2-B)	Side-turn signal light (LH)	A-27X	(4)	Fuel pump relay 1
A-13	(22)	Front wiring harness and control wiring harness combination	A-28X	(4)	Starter relay

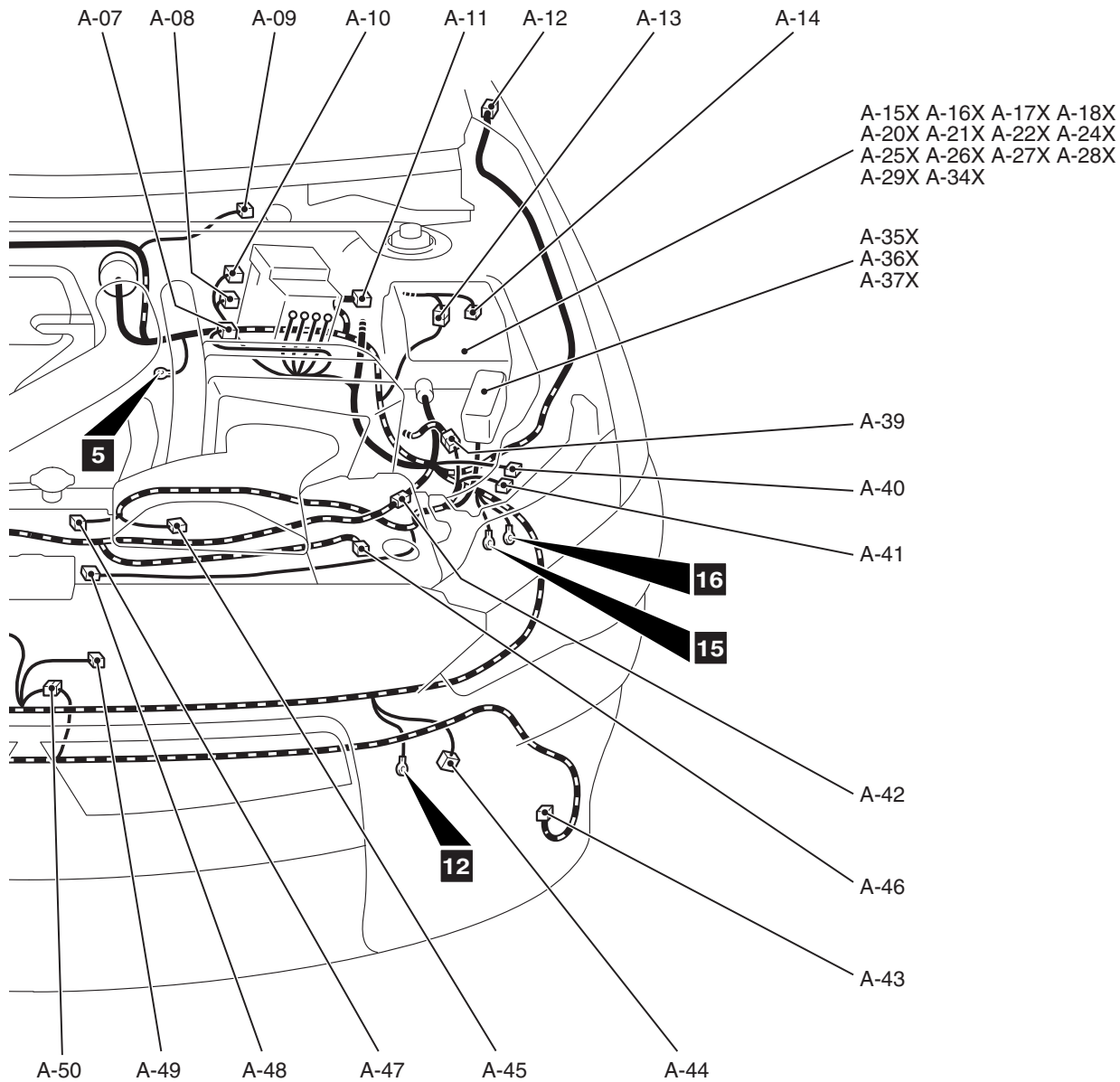

AC901350AB

A-29X (4)	Headlight relay (Low)	A-47 (2-B)	Condenser fan motor
A-34X (4)	MFI relay	A-48 (2-B)	Hood switch
A-35X (4)	Radiator fan relay	A-49 (2-B)	Ambient air temperature sensor
A-36X (4)	Condenser fan relay	A-50 (2-B)	Front wiring harness and fog light wiring harness combination
A-37X (5)	Fan control relay	A-51 (1-B)	Horn (Low)
A-39 (6-B)	Front wiring harness and control wiring harness combination	A-52 (2-Y)	Front impact sensor (RH)
A-40 (12-B)	Headlight assembly (LH)	A-53 (3-B)	A/C pressure sensor
A-41 (6-B)	Headlight assembly (LH)	A-54 (2-B)	Fog light (RH)
A-42 (4-B)	Front wiring harness and front impact sensor wiring harness combination	A-55 (2-B)	No connection
A-43 (2-B)	Fog light (LH)	A-56 (6-B)	Headlight assembly (RH)
A-44 (1-B)	Horn (High)	A-57 (12-B)	Headlight assembly (RH)
A-45 (2-B)	Radiator fan motor	A-58 (2-B)	Fuel pump circuit resistor
A-46 (2-Y)	Front impact sensor (LH)	A-59 (1-B)	Theft-alarm horn

ENGINE AND TRANSAXLE

M1801000404090

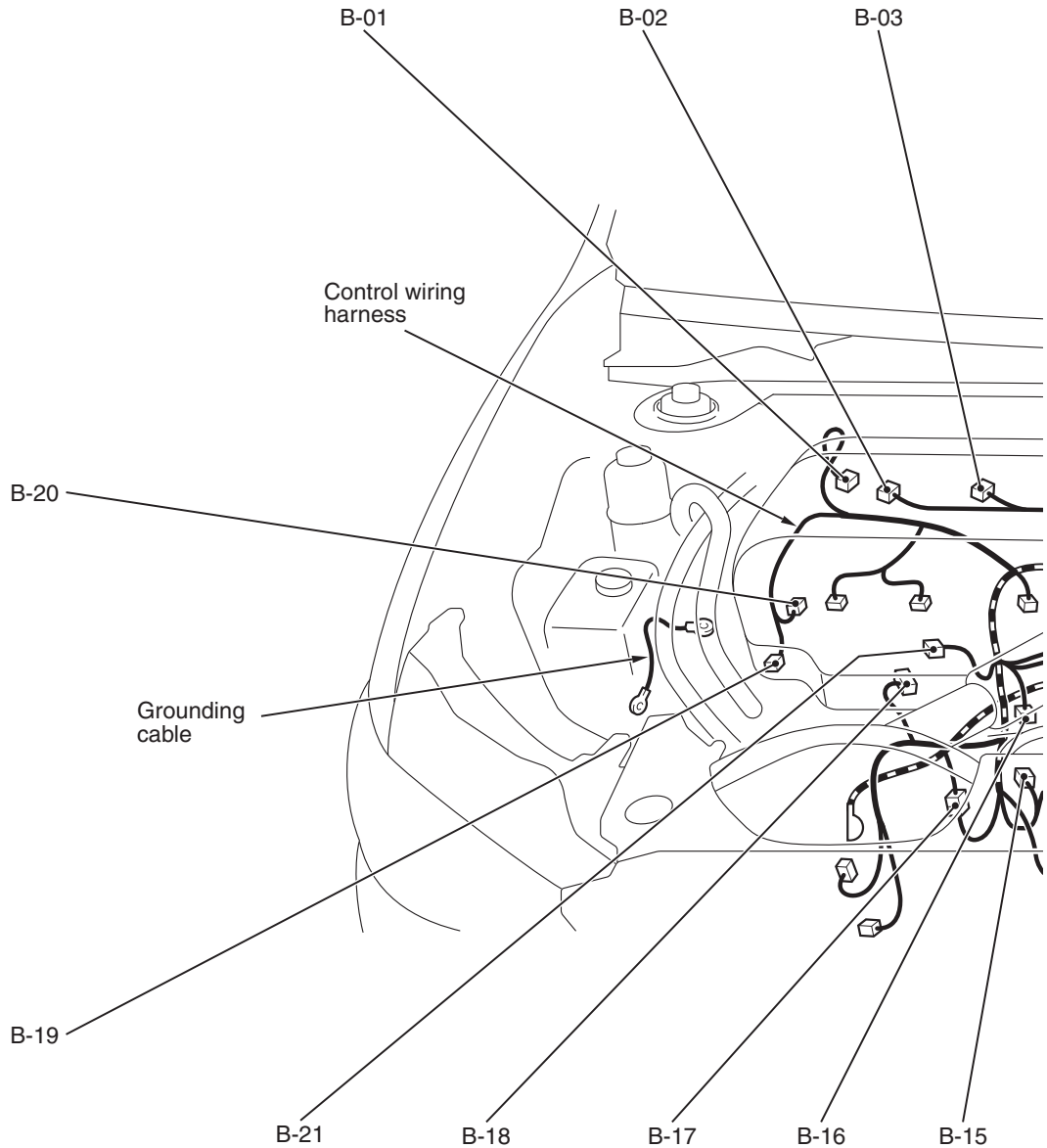
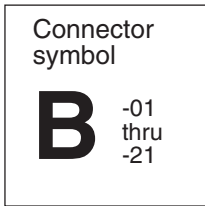

Connector color code
 B: Black
 BR: Brown
 G: Green
 GR: Gray
 L: Blue
 NONE: Milk white
 O: Orange
 R: Red
 V: Violet
 Y: Yellow

AC902430AB

- B-01 (2) Exhaust oil feeder control valve
- B-02 (4-GR) Ignition coil 1
- B-03 (4-GR) Ignition coil 2
- B-04 (4-GR) Ignition coil 3
- B-05 (3-GR) Exhaust camshaft position sensor

- B-06 (4-GR) Ignition coil 4
- B-07 (3-GR) Intake camshaft position sensor
- B-08 (2-B) Engine coolant temperature sensor
- B-09 (64-GR) Engine control module
- B-10 (48-GR) Engine control module

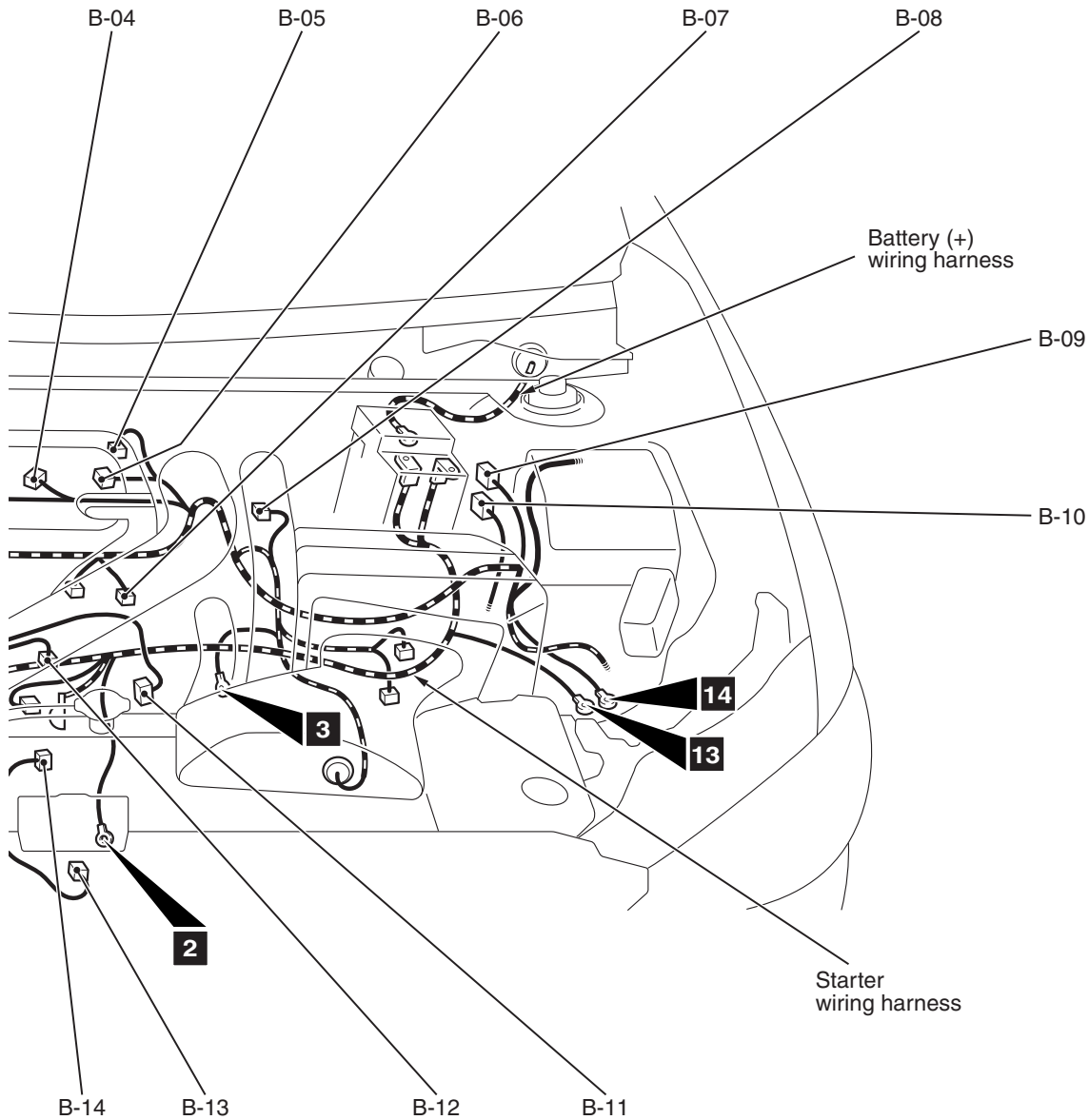

AC708213AB

- | | | | | | |
|------|--------|-------------------------------------|------|-------|---|
| B-11 | (6-B) | Throttle body assembly | B-17 | (1-B) | Control wiring harness and starter wiring harness combination |
| B-12 | (2-B) | Evaporative emission purge solenoid | B-18 | (3-B) | Manifold absolute pressure sensor |
| B-13 | (3-GR) | Crankshaft position sensor | B-19 | (1) | Power steering pressure switch |
| B-14 | (2-B) | Knock sensor | B-20 | (2) | Intake engine oil feeder control valve |
| B-15 | (1) | Engine oil pressure switch | B-21 | (1-B) | Capacitor |
| B-16 | (2-B) | Intake air temperature sensor 2 | | | |

ENGINE AND TRANSAXLE (CONTINUED)

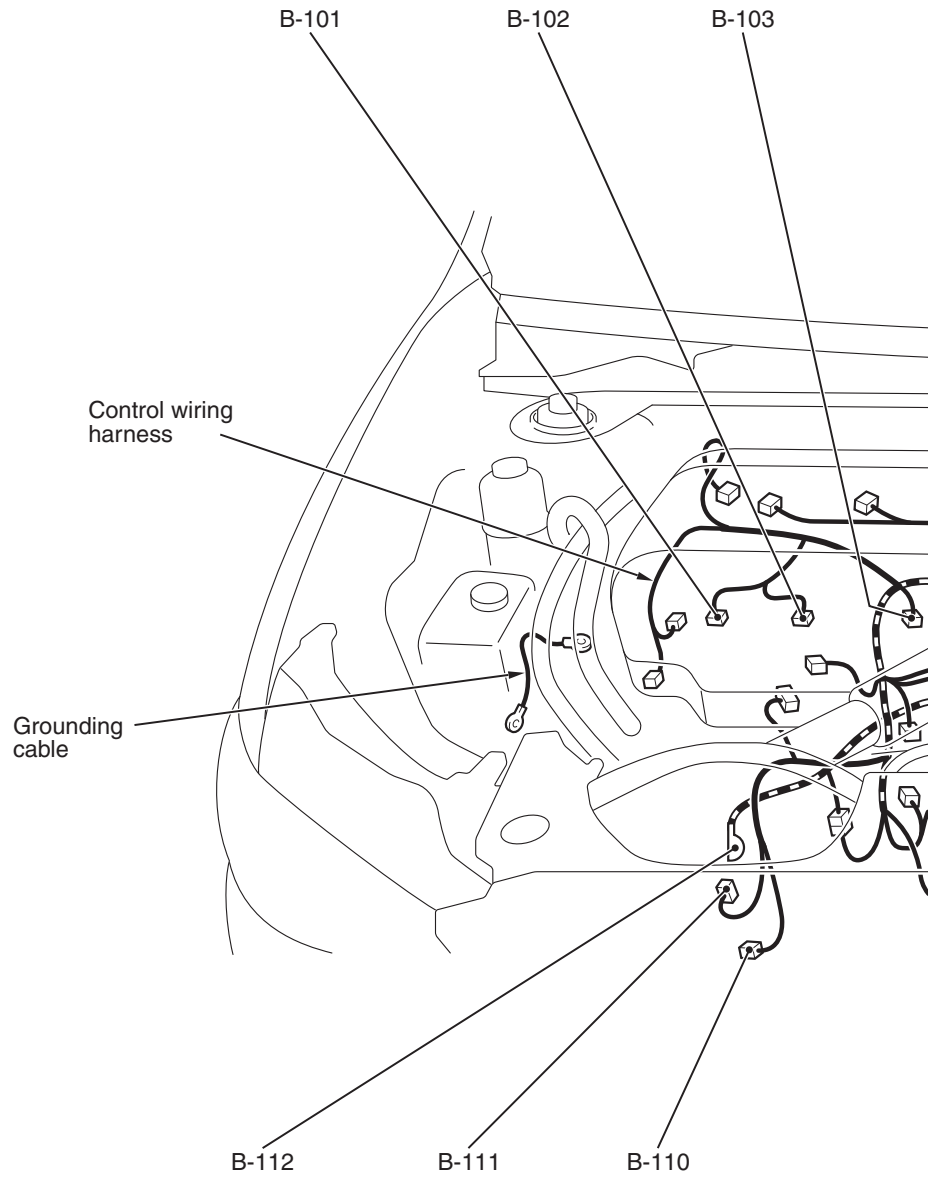
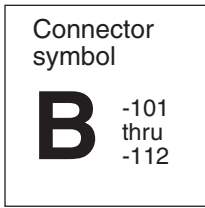

- Connector color code
- B: Black
 - BR: Brown
 - G: Green
 - GR: Gray
 - L: Blue
 - NONE: Milk white
 - O: Orange
 - R: Red
 - V: Violet
 - Y: Yellow

- B-101 (2-GR) Injector 1
- B-102 (2-GR) Injector 2
- B-103 (2-GR) Injector 3

- B-104 (2-GR) Injector 4
- B-105 (2-B) Backup light switch <M/T>
- B-106 (2-GR) 1st & 2nd rail switch <M/T>

AC902430AC

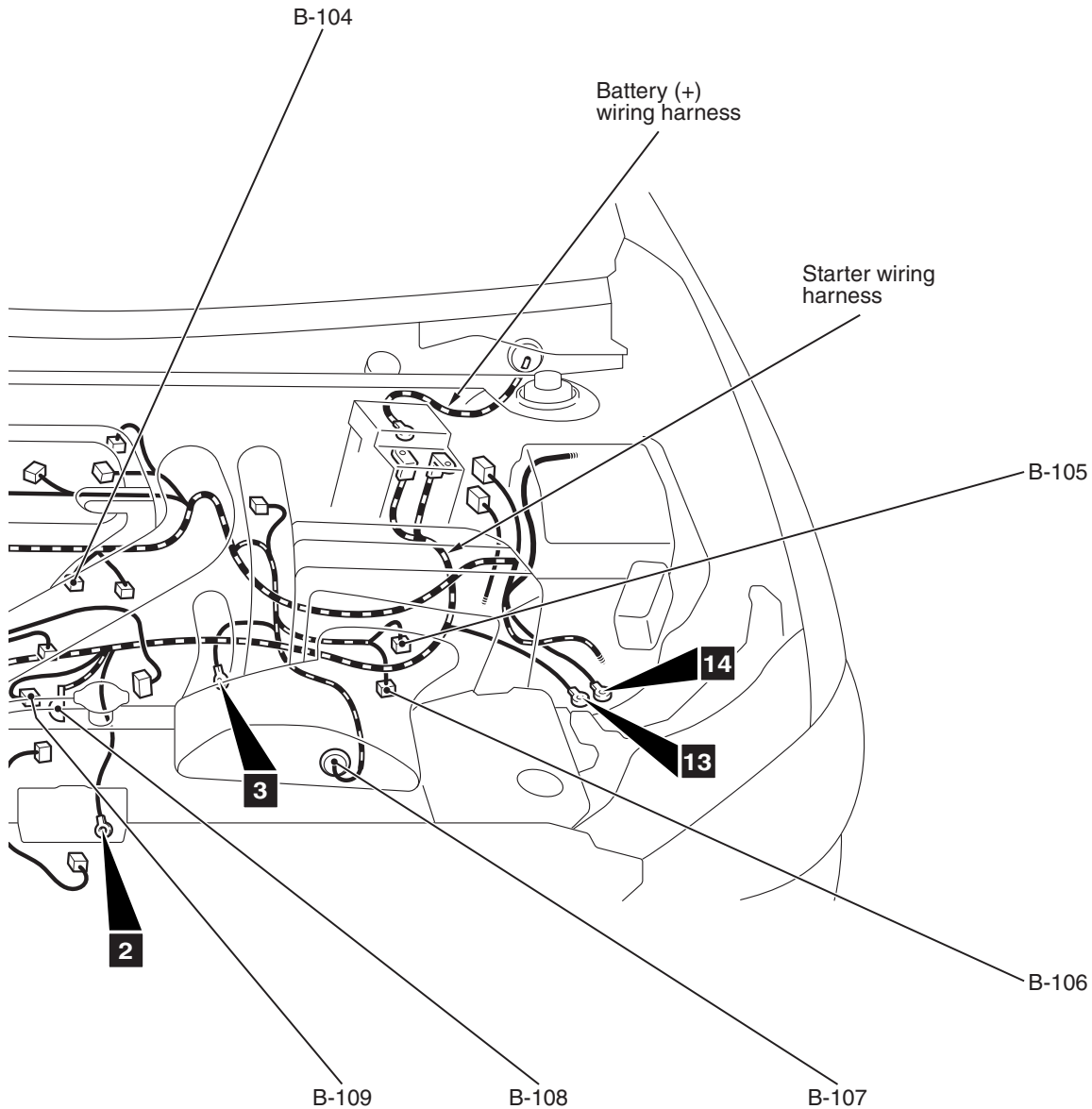

AC708213AC

B-107 (20-B) Transaxle assembly <TC-SST>
 B-108 (1) Starter
 B-109 (1-B) Starter

B-110 (1-B) A/C compressor clutch assembly
 B-111 (4-GR) Generator
 B-112 (1) Generator

DASH PANEL

M1801000603950

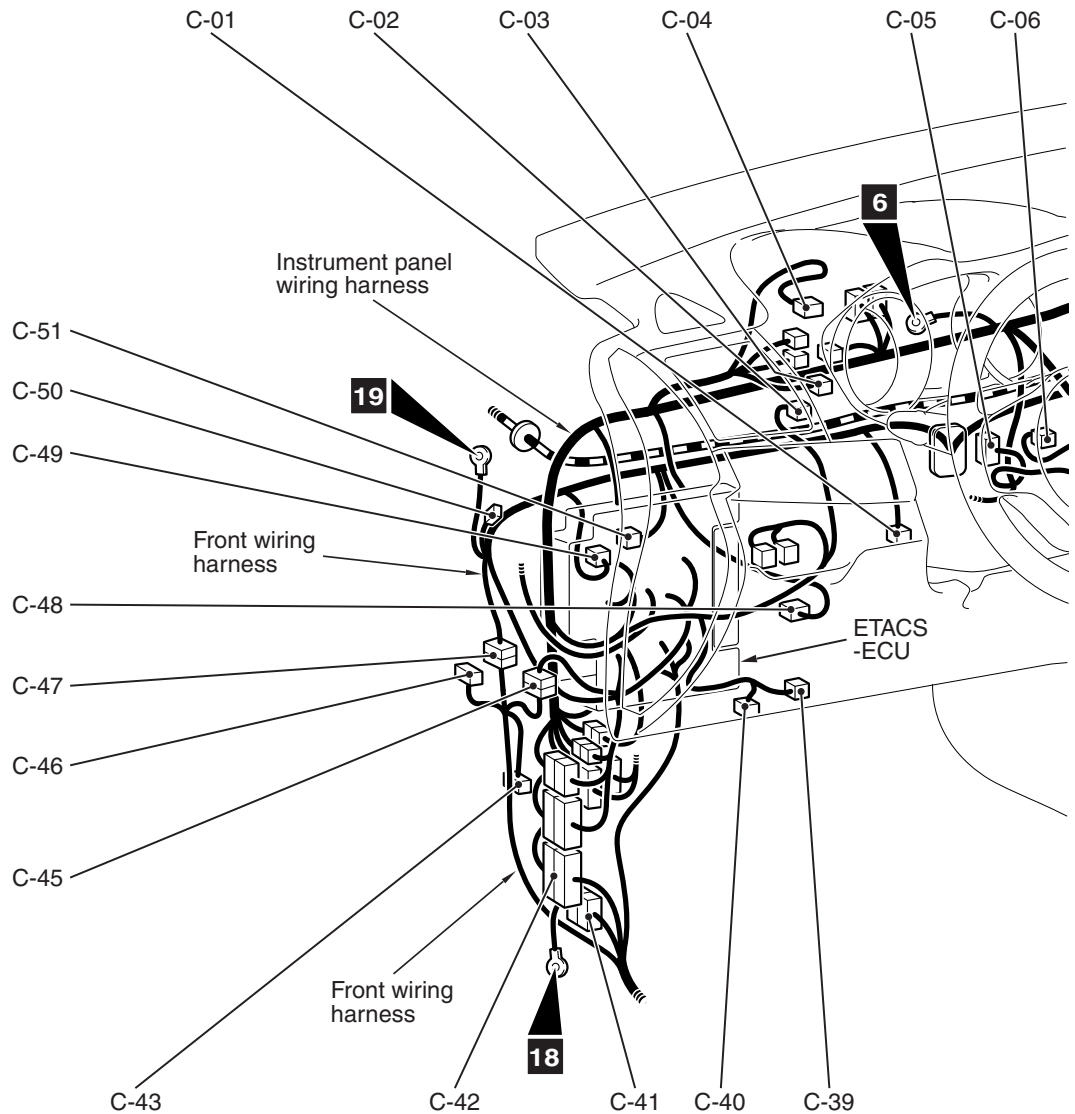
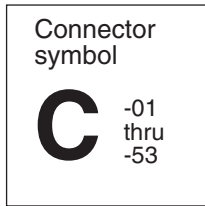

- Connector color code
- B: Black
 - BR: Brown
 - G: Green
 - GR: Gray
 - L: Blue
 - NONE: Milk white
 - O: Orange
 - R: Red
 - V: Violet
 - Y: Yellow

AC901352AB

C-01	(6-B)	Accelerator pedal position sensor	C-14	(4-Y)	Passenger's (Front) air bag module (squib)
C-02	(4)	Meter information switch	C-15	(10)	CAN box unit
C-03	(6)	No connection	C-16	(24-B)	Joint connector (6)
C-04	(24)	Combination meter	C-17	(10)	No connection
C-05	(40)	KOS-ECU	C-18	(14)	Satellite radio tuner
C-06	(2)	Interior temperature sensor	C-19	(24)	No connection
C-07	(12)	Wireless control module <Vehicles without KOS>	C-20	(16-B)	A/C-ECU <Vehicles with air conditioning system>
C-08	(12)	Receiver antenna module <Vehicles with KOS>	C-21	(1-GR)	Front wiring harness and floor wiring harness combination
C-09	(7)	Multivision display <Vehicles with MMCS>	C-22	(20-B)	A/C-ECU <Vehicles with air conditioning system>
C-10	(32-GR)	Multivision display <Vehicles with MMCS>	C-23	(20)	Instrument panel wiring harness and floor wiring harness combination
C-11	(24)	Hands free module	C-24	(24)	Instrument panel wiring harness and floor wiring harness combination
C-12	(5-GR)	Multivision display <Vehicles with MMCS>	C-25	(2)	Accessory socket
C-13	(17-GR)	Multivision display <Vehicles with MMCS>			

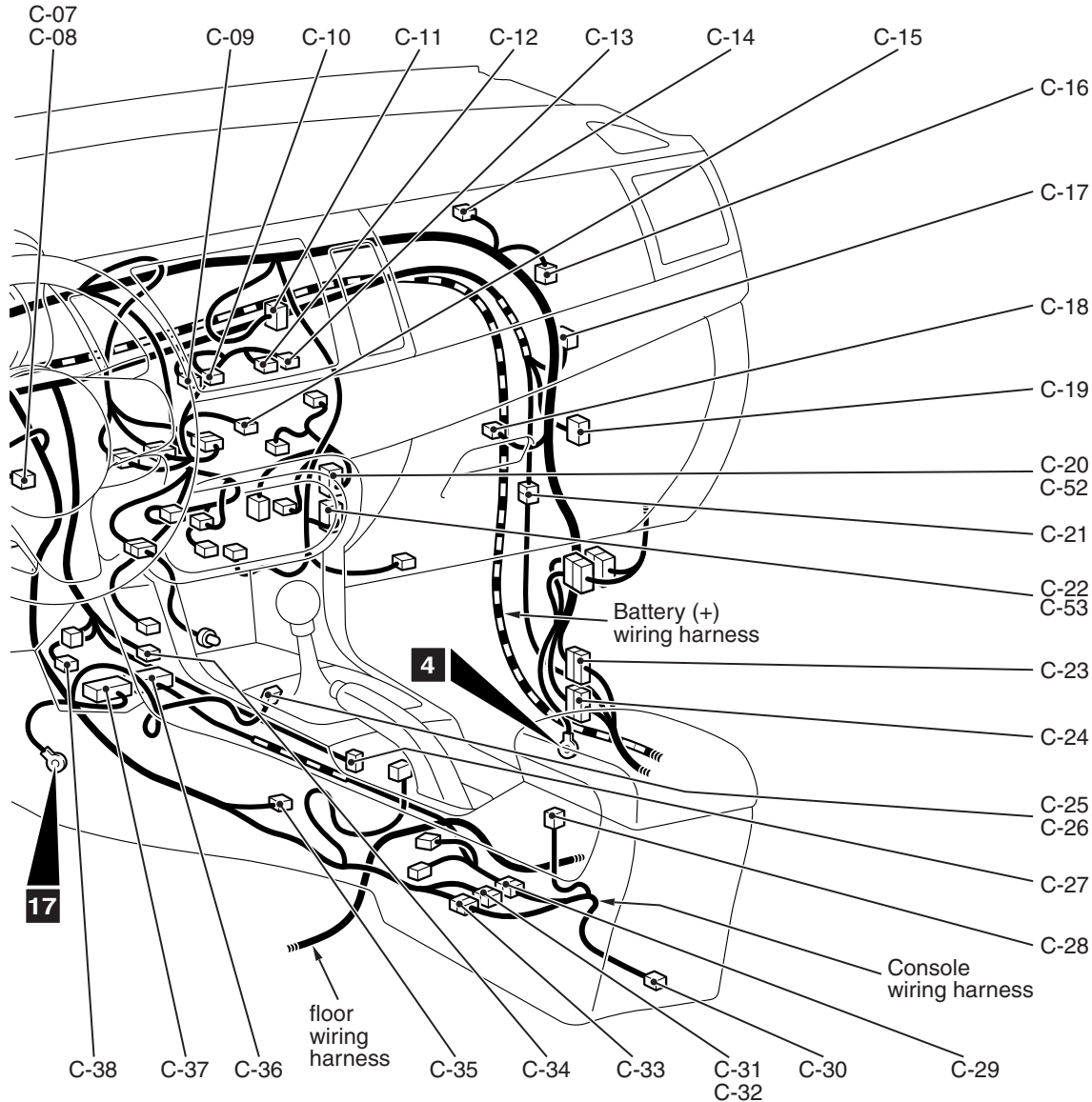

AC901353AB

C-26	(2)	Cigarette lighter	C-40	(16-B)	Data link connector
C-27	(16)	Shift lever <TC-SST>	C-41	(24)	Instrument panel wiring harness and floor wiring harness combination
C-28	(9)	Heated seat switch	C-42	(20)	Instrument panel wiring harness and floor wiring harness combination
C-29	(4)	Floor wiring harness and console wiring harness combination	C-43	(24-B)	Joint connector (4)
C-30	(2)	No connection	C-45	(6)	Front wiring harness and floor wiring harness combination
C-31	(7-B)	Jumper connector <Vehicles without steering wheel audio remote control switch>	C-46	(26)	S-AWC-ECU
C-32	(7)	Jumper connector <Vehicles with steering wheel audio remote control switch>	C-47	(22)	Front wiring harness and floor wiring harness combination
C-33	(6)	Instrument panel wiring harness and console wiring harness combination	C-48	(4)	Stoplight switch
C-34	(4-B)	Heated oxygen sensor (Front)	C-49	(2)	Clutch pedal position switch <M/T>
C-35	(10)	Selector lever assembly <TC-SST>	C-50	(24-B)	Joint connector (7)
C-36	(32-Y)	SRS-ECU	C-51	(2)	Clutch interlock switch <M/T>
C-37	(24-Y)	SRS-ECU	C-52	(16-B)	Heater control module <Vehicles without air conditioning system>
C-38	(6-B)	G and yaw rate sensor	C-53	(20-B)	Heater control module <Vehicles without air conditioning system>
C-39	(2-B)	Knee air bag module (squib)			

DASH PANEL (CONTINUED)

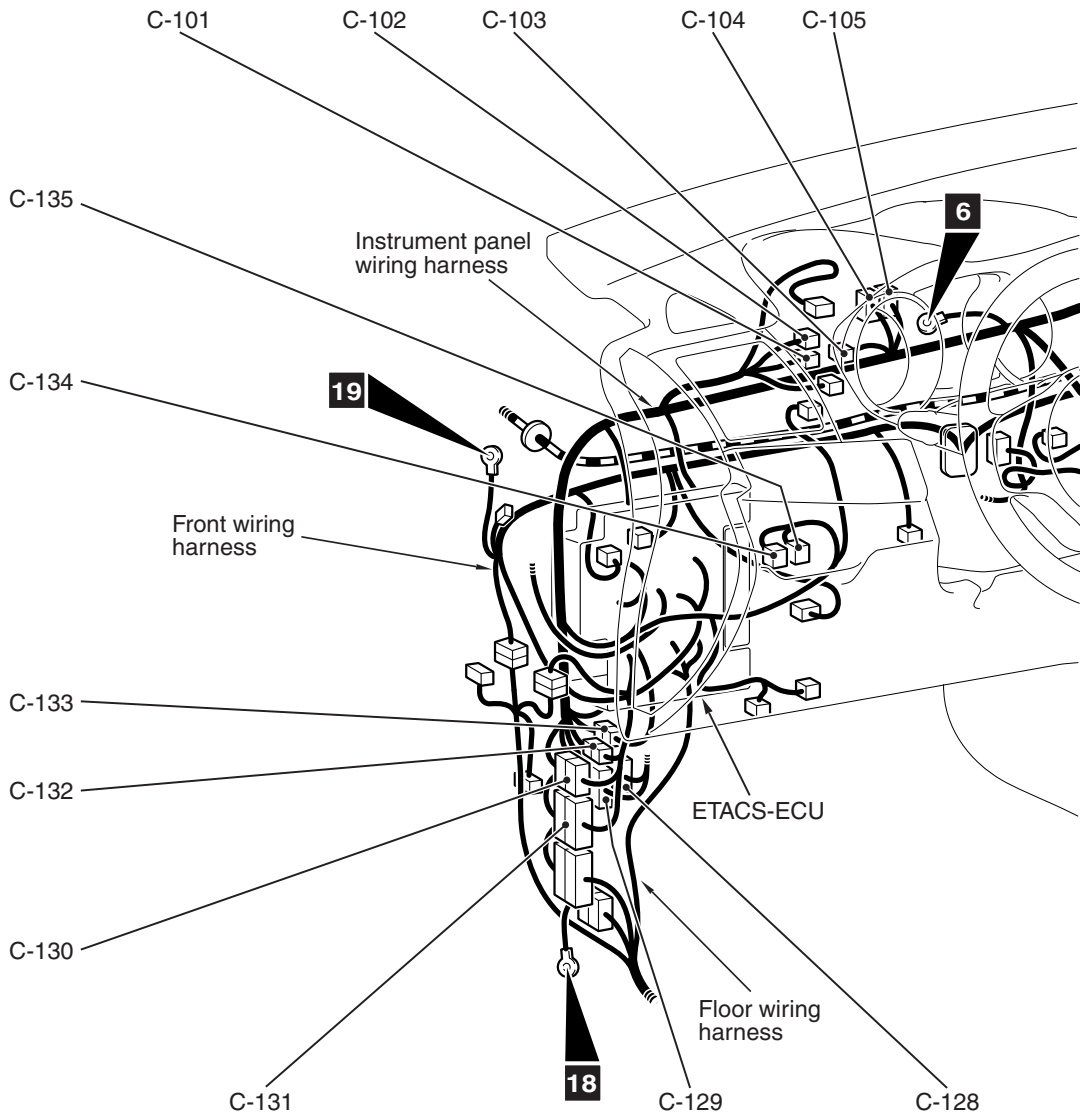
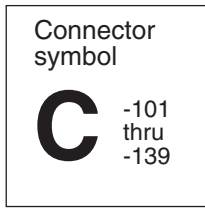

- Connector color code
- B: Black
 - BR: Brown
 - G: Green
 - GR: Gray
 - L: Blue
 - NONE: Milk white
 - O: Orange
 - R: Red
 - V: Violet
 - Y: Yellow

AC901352AC

C-101 (24-B)	Joint connector (1)	C-111 (5)	Outside/inside air selection damper control motor
C-102 (12-B)	Joint connector (2)	C-112 (5)	Mode selection damper control motor
C-103 (24-B)	Joint connector (3)	C-113 (2)	Fin thermo sensor
C-104 (24)	Joint connector (CAN2)	C-114 (5)	Air mixing damper control motor
C-105 (24)	Joint connector (CAN1)	C-115 (2)	Blower motor
C-106 (24)	Instrument panel wiring harness and multivision display wiring harness combination <Vehicles with MMCS>	C-116 (12)	Instrument panel wiring harness and front door wiring harness (RH) combination
C-107 (20)	Radio and CD player <Vehicles without MMCS>	C-117 (24-BR)	Instrument panel wiring harness and front door wiring harness (RH) combination
C-108 (20)	Instrument panel wiring harness and multivision display wiring harness combination <Vehicles with MMCS>	C-118 (2)	Radio antenna
C-109 (18)	Radio and CD player <Vehicles without MMCS>	C-119 (4)	Power transistor
C-110 (18)	Instrument panel wiring harness and multivision display wiring harness combination <Vehicles with MMCS>	C-120 (6)	AWC switch <Vehicles with steering wheel audio remote control switch>

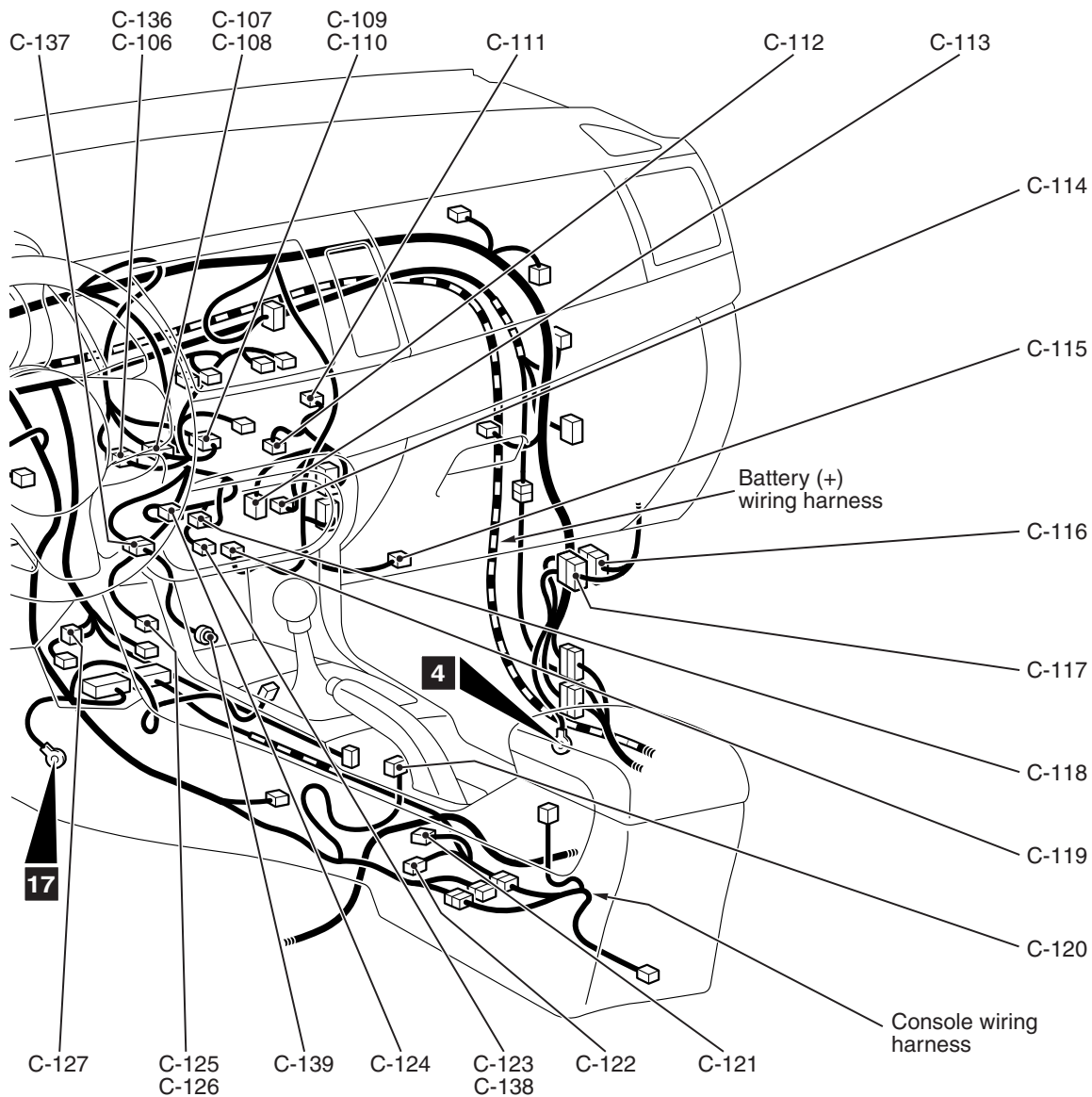

AC901353AC

C-121 (3)	Inside transmission antenna assembly (Front) <Vehicles with KOS>	C-130 (16-BR)	Instrument panel wiring harness and front wiring harness combination
C-122 (1-B)	Parking brake switch	C-131 (22)	Instrument panel wiring harness and front wiring harness combination
C-123 (12)	A/C control panel <Vehicles with air conditioning system>	C-132 (2)	Instrument panel wiring harness and front wiring harness combination
C-124 (16)	Center panel unit	C-133 (12)	Instrument panel wiring harness and roof wiring harness combination
C-125 (6-B)	Audio adapter <Vehicles without MMCS>	C-134 (6-GR)	Headlight leveling switch
C-126 (6-B)	Audio and video adapter <Vehicles with MMCS>	C-135 (6)	ASC off switch
C-127 (24)	Joint connector (CAN3)	C-136 (24)	Spare connector (for navigation unit)
C-128 (12)	Instrument panel wiring harness and front door wiring harness (LH) combination	C-137 (2)	Instrument panel wiring harness and cigarette lighter illumination wiring harness combination
C-129 (24-BR)	Instrument panel wiring harness and front door wiring harness (LH) combination	C-138 (12)	Heater control panel <Vehicles without air conditioning system>
		C-139 (2)	Cigarette lighter illumination light

DASH PANEL (CONTINUED)

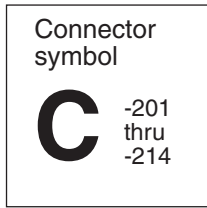

Steering column

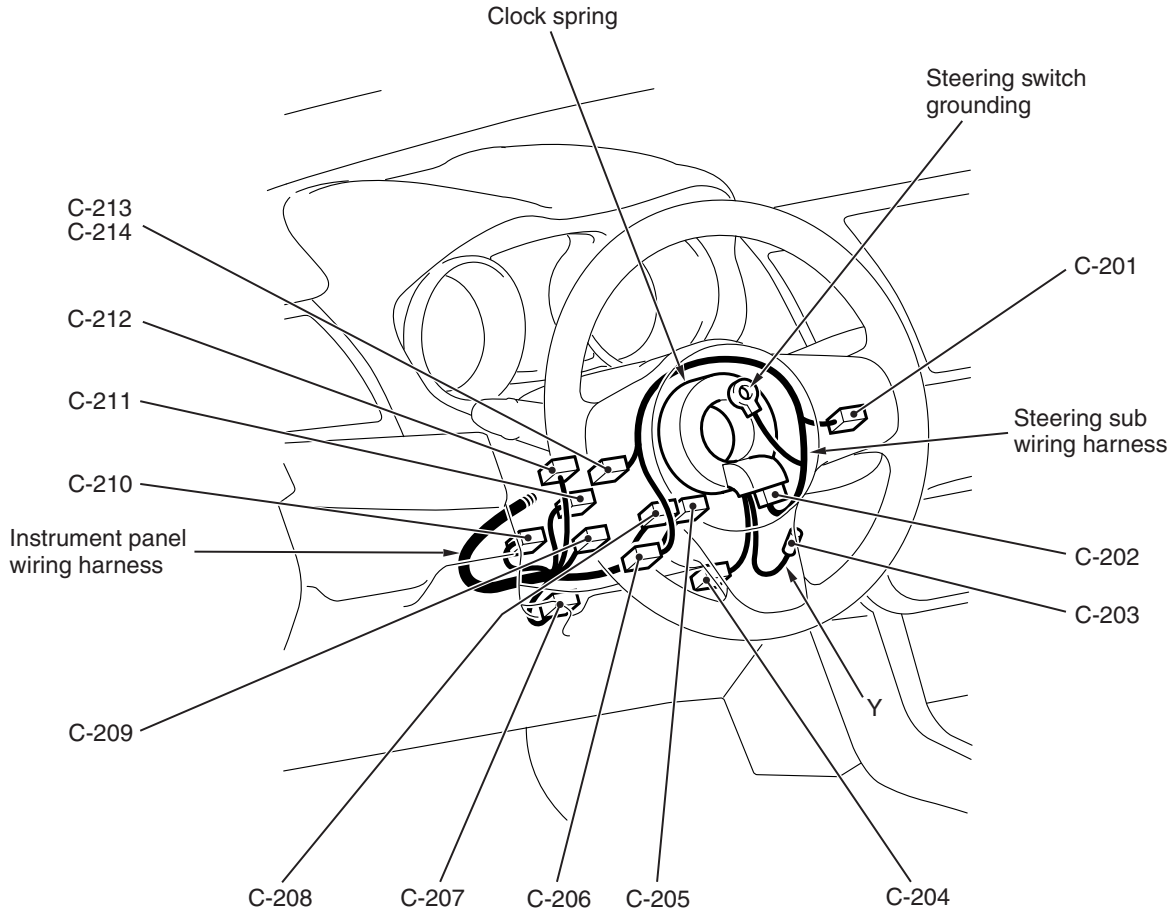

AC708217AB

- | | | | |
|-------------|--|-------------|--|
| C-201 (4-L) | Cruise control switch | C-208 (4-Y) | Clock spring |
| C-202 (5) | Clock spring and steering sub wiring harness combination | C-209 (5) | Steering wheel sensor |
| C-203 (1) | Horn switch | C-210 (6) | Ignition switch |
| C-204 (4-Y) | Driver's air bag module (squib) | C-211 (12) | Key reminder switch |
| C-205 (6) | Clock spring | C-212 (10) | Column switch |
| C-206 (4-Y) | Steering wheel voice control switch <Vehicles with steering wheel audio remote control switch> | C-213 (5-R) | Steering wheel audio remote control switch |
| C-207 (3) | Paddle shift switch <TC-SST> | C-214 (5-R) | AWC switch <Vehicles without steering wheel audio remote control switch> |

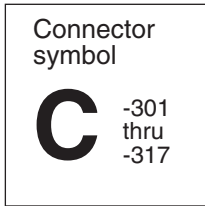

ETACS-ECU

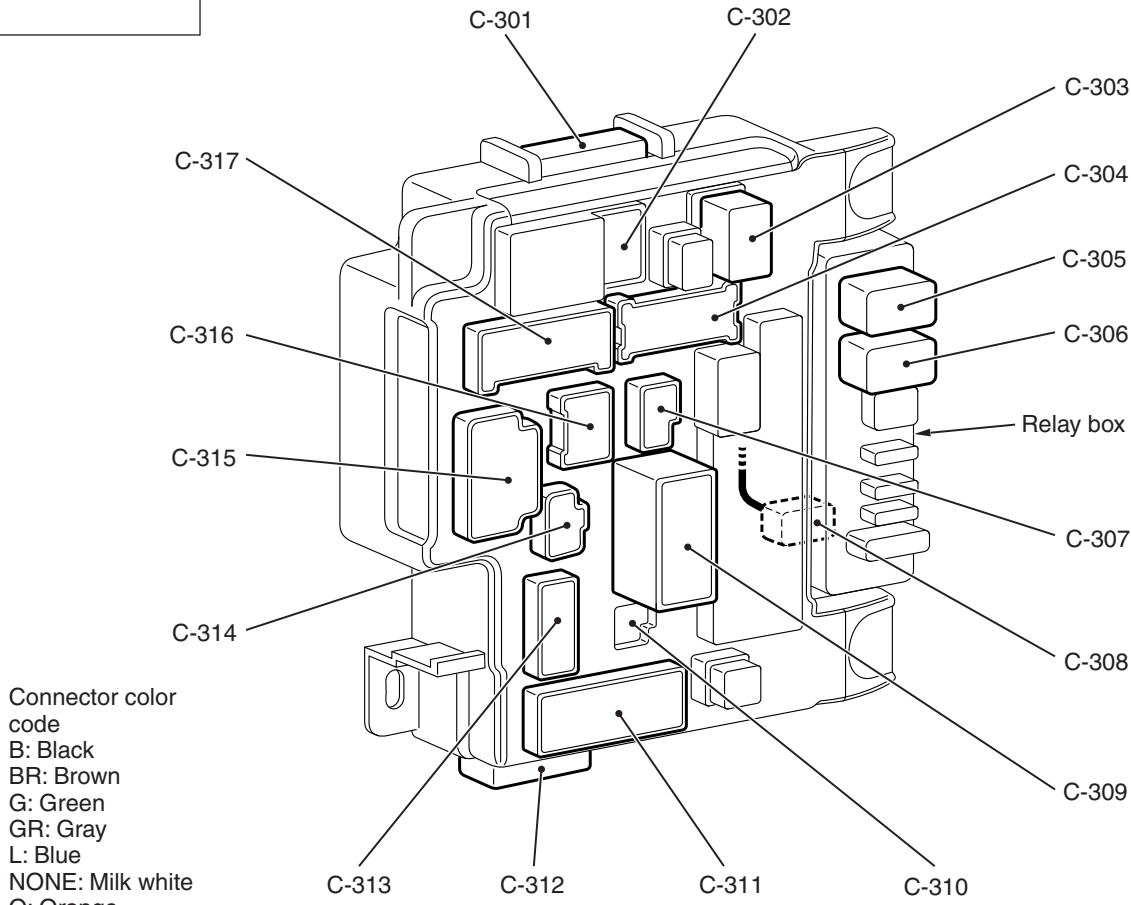

- Connector color code
 B: Black
 BR: Brown
 G: Green
 GR: Gray
 L: Blue
 NONE: Milk white
 O: Orange
 R: Red
 V: Violet
 Y: Yellow

AC607744AD

C-301 (24)	Instrument panel wiring harness and ETACS-ECU combination	C-311 (20)	Floor wiring harness and ETACS-ECU combination
C-302 (4)	No connection	C-312 (16)	Front wiring harness and ETACS-ECU combination
C-303 (4)	Blower relay	C-313 (16-BR)	Floor wiring harness and ETACS-ECU combination
C-304 (16)	Front wiring harness and ETACS-ECU combination	C-314 (2)	Floor wiring harness and ETACS-ECU combination
C-305 (4)	Heated seat relay	C-315 (19)	Instrument panel wiring harness and ETACS-ECU combination
C-306 (4)	Rear window defogger relay	C-316 (6)	Roof wiring harness and ETACS-ECU combination
C-307 (2-B)	Front wiring harness and ETACS-ECU combination	C-317 (15)	Instrument panel wiring harness and ETACS-ECU combination
C-308 (1-GR)	Instrument panel wiring harness and relay box combination		
C-309 (2-B)	Front wiring harness and ETACS-ECU combination		
C-310 (4)	No connection		

FLOOR AND ROOF

M1801000904545

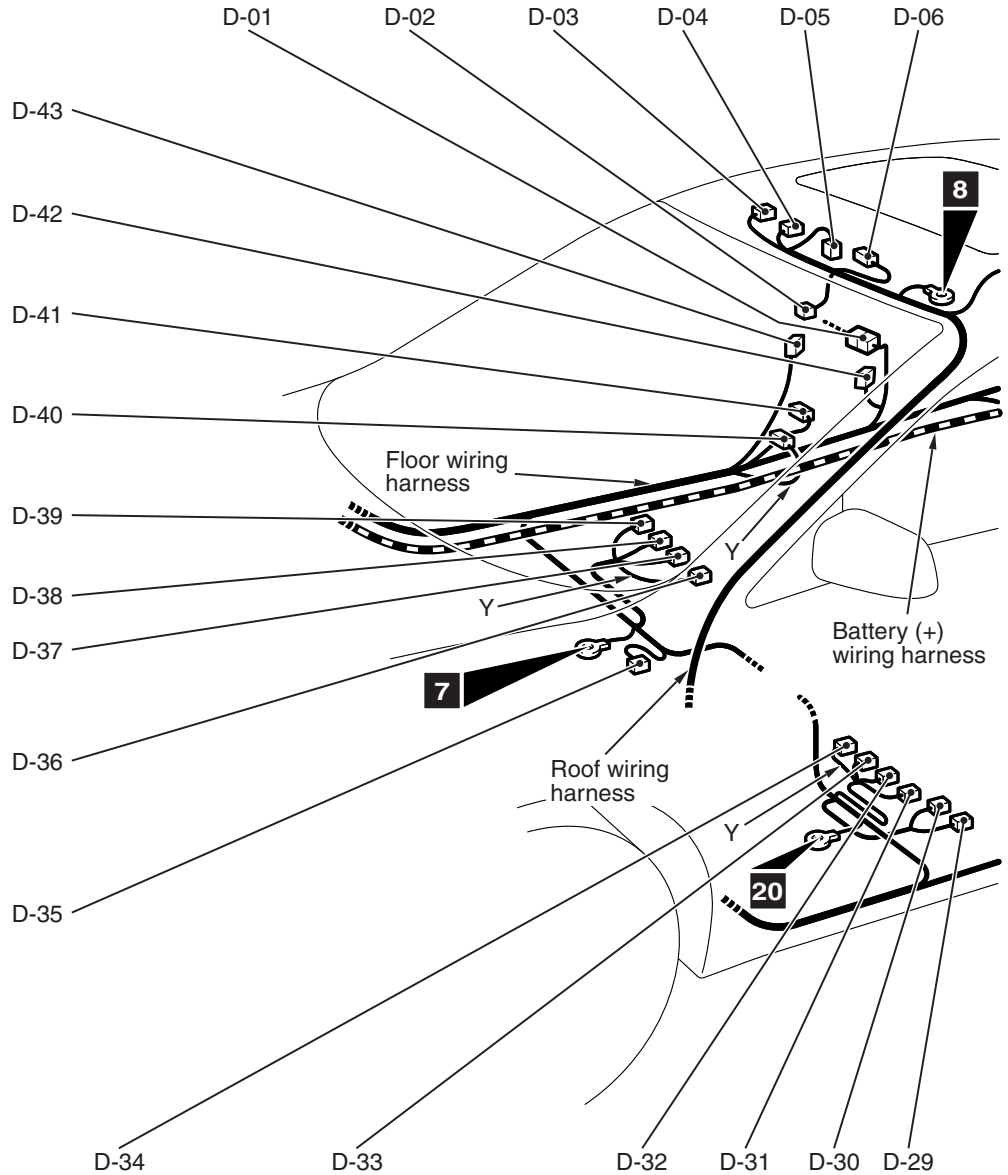
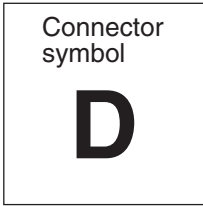

- Connector color code
- B : Black
 - BR : Brown
 - G : Green
 - GR : Gray
 - L : Blue
 - None : Milk white
 - O : Orange
 - R : Red
 - V : Violet
 - Y : Yellow

- D-01 (10) Floor wiring harness and rear door wiring harness (RH) combination
- D-02 (4) Lighting control sensor <Vehicles with automatic light>
- D-03 (3) Front dome light
- D-04 (3) Microphone unit
- D-05 (6-B) Sunroof switch
- D-06 (10-GR) Sunroof motor assembly
- D-07 (2-GR) Rear dome light
- D-08 (3) Rear door switch (RH)
- D-09 (2-B) Rear wheel speed sensor (RH)
- D-10 (2-Y) Floor wiring harness and rear floor wiring harness (RH) combination
- D-11 (22) Floor wiring harness and rear floor wiring harness (RH) combination

- D-12 (1-GR) Floor wiring harness and rear floor wiring harness (RH) combination
- D-13 (2) Fuel level sensor (sub)
- D-14 (12) Receiver antenna assembly
- D-15 (2-Y) Floor wiring harness and rear floor wiring harness (LH) combination
- D-16 (18) Floor wiring harness and rear floor wiring harness (LH) combination
- D-17 (24-BR) Floor wiring harness and rear floor wiring harness (LH) combination
- D-18 (2-B) Rear wheel speed sensor (LH)
- D-19 (3) Rear door switch (LH)
- D-20 (2-B) Washer motor
- D-21 (3-B) Fuel tank differential pressure sensor

AC708219AB

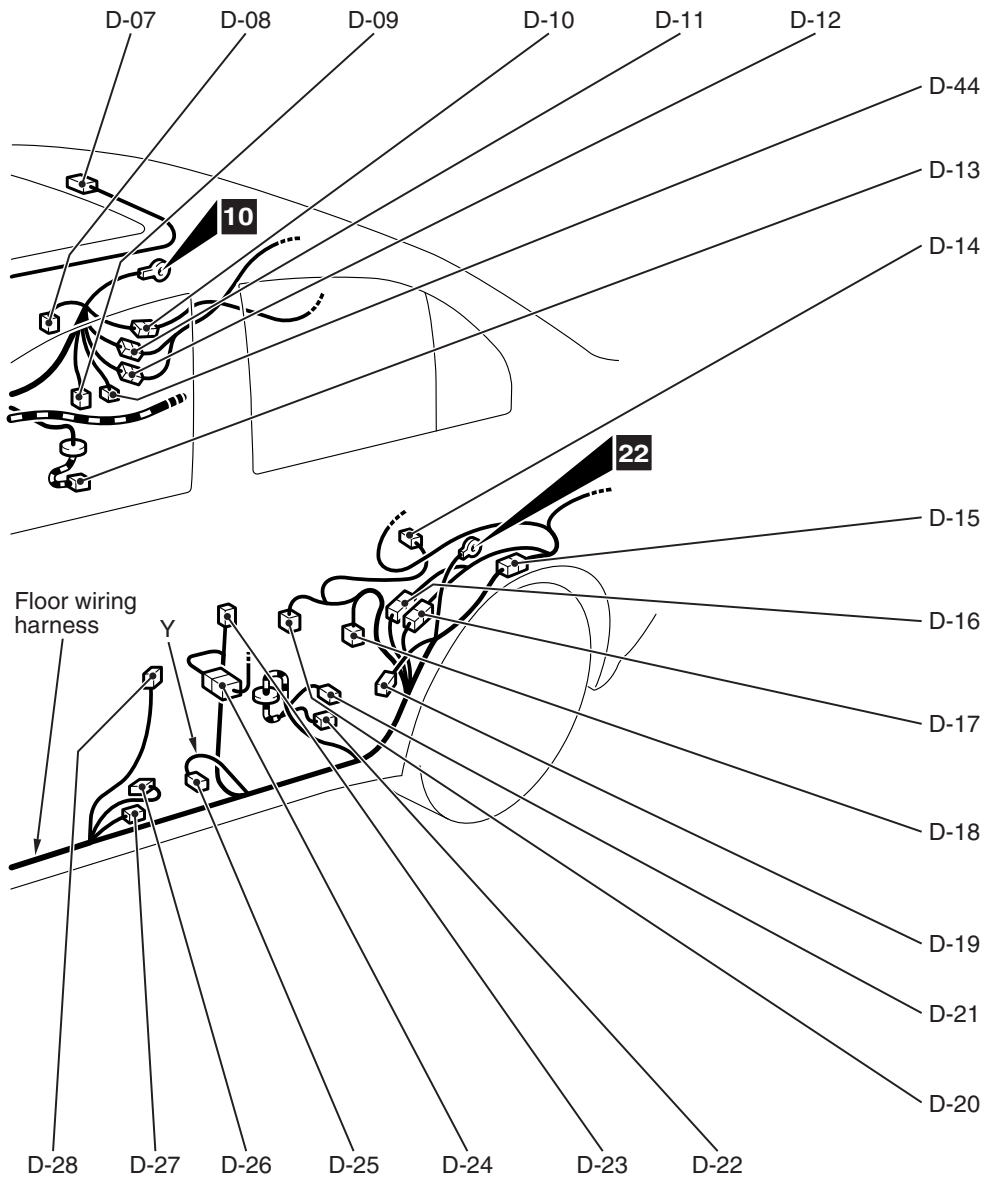

AC804433AB

D-22	(5-GR)	Fuel pump module	D-33	(4)	Seat belt switch (Driver's side)
D-23	(3)	Outside transmission antenna assembly (Driver's side) <Vehicles with KOS>	D-34	(2-Y)	Side-airbag module (squib) (LH)
D-24	(10)	Floor wiring harness and rear door wiring harness (LH) combination	D-35	(4-B)	Heated oxygen sensor (Rear)
D-25	(2-B)	Seat belt pre-tensioner (LH)	D-36	(2-Y)	Side-airbag module (squib) (RH)
D-26	(2-Y)	Side impact sensor (LH)	D-37	(2)	Seat belt switch (Passenger's side)
D-27	(12-B)	Joint connector (5)	D-38	(4-B)	Heated seat assembly (RH)
D-28	(3)	Front door switch (LH)	D-39	(6)	Front seat assembly (RH)
D-29	(18)	Audio amplifier	D-40	(2-B)	Seat belt pre-tensioner (RH)
D-30	(14)	Audio amplifier	D-41	(2-Y)	Side impact sensor (RH)
D-31	(4-B)	Heated seat assembly (LH)	D-42	(3)	Outside transmission antenna assembly (Passenger's side) <Vehicles with KOS>
D-32	(2-GR)	Seat slide sensor	D-43	(3)	Front door switch (RH)
			D-44	(3)	No connection

DOOR

M1801001402310

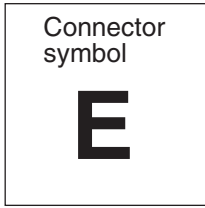

FRONT DOOR

(Driver's side)

(Passenger's side)

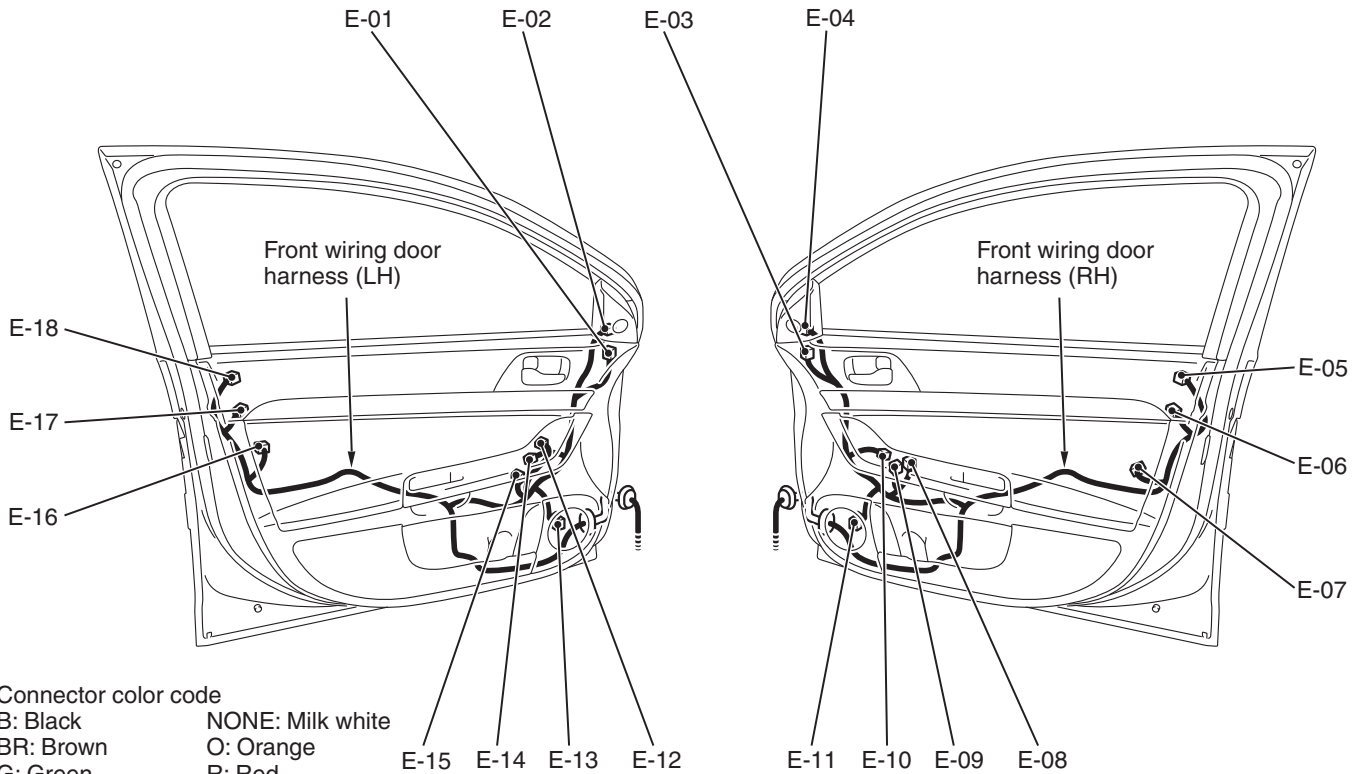

AC605712AC

- | | | | | | |
|------|--------|--|------|--------|---------------------------------|
| E-01 | (10) | Door mirror assembly (LH) | E-08 | (4) | Front power window sub switch |
| E-02 | (2-B) | Tweeter (LH) | E-09 | (8) | Front power window sub switch |
| E-03 | (10) | Door mirror assembly (RH) | E-10 | (6-GR) | Front power window motor (RH) |
| E-04 | (2-B) | Tweeter (RH) | E-11 | (2) | Front door speaker (RH) |
| E-05 | (6) | Unlock sensor (RH) <Vehicles with KOS> | E-12 | (11-L) | Remote controlled mirror switch |
| E-06 | (2-GR) | Lock switch (RH) <Vehicles with KOS> | E-13 | (2) | Front door speaker (LH) |
| E-07 | (6-B) | Front door lock actuator (RH) | E-14 | (6-GR) | Front power window motor (LH) |
| | | | E-15 | (19) | Power window main switch |

REAR DOOR

(LH)

(RH)

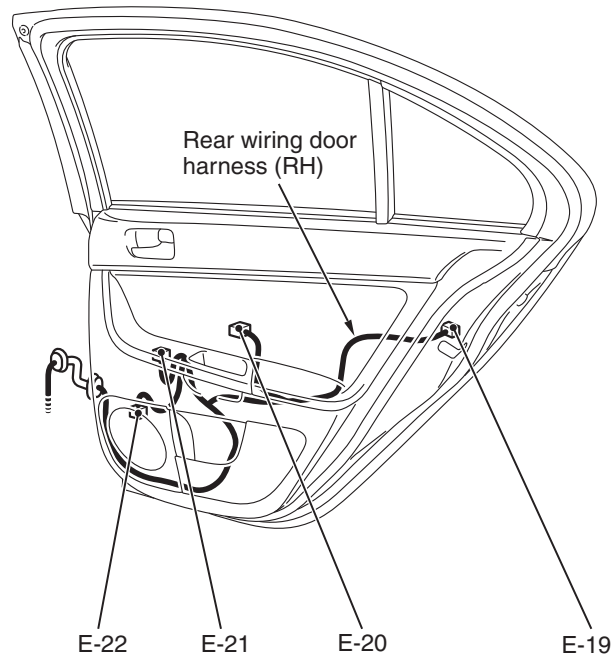
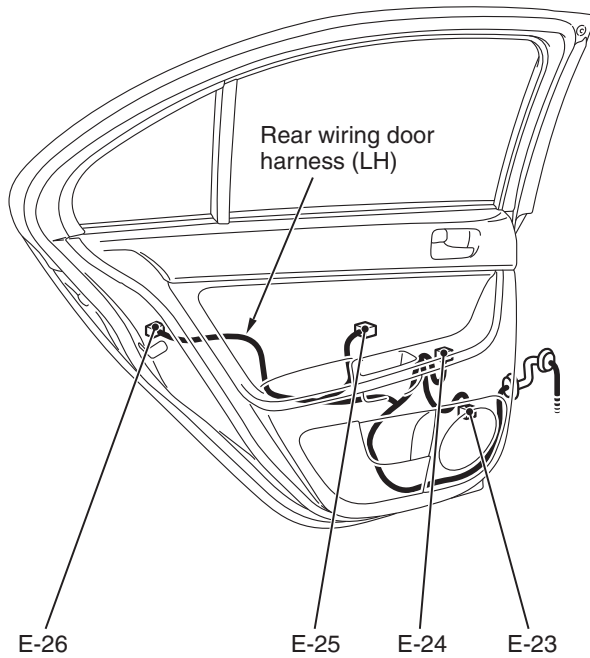

AC605713AE

- E-16 (6-B) Front door lock actuator (LH)
- E-17 (2-GR) Lock switch (LH) <Vehicles with KOS>
- E-18 (6) Unlock sensor (LH) <Vehicles with KOS>
- E-19 (6-B) Rear door lock actuator (RH)
- E-20 (6-GR) Rear power window motor (RH)

- E-21 (8) Rear power window sub switch (RH)
- E-22 (2) Rear door speaker (RH)
- E-23 (2) Rear door speaker (LH)
- E-24 (8) Rear power window sub switch (LH)
- E-25 (6-GR) Rear power window motor (LH)
- E-26 (6-B) Rear door lock actuator (LH)

LUGGAGE COMPARTMENT

M1801001501358

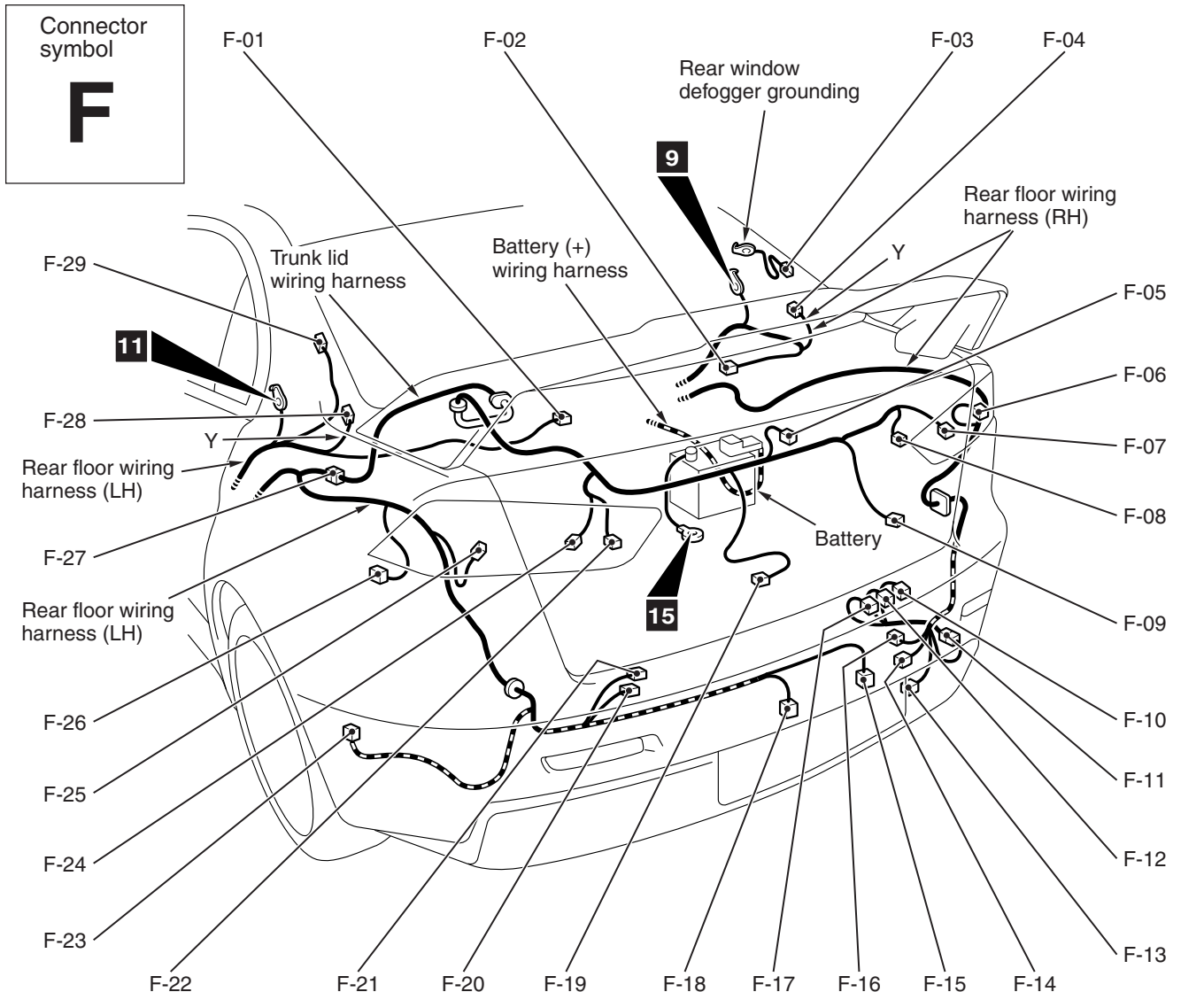

AC708221AB

- | | | | | | |
|------|--------|---|------|--------|---|
| F-01 | (2) | Luggage compartment light | F-17 | (3-B) | Proportioning valve (for AYC control) |
| F-02 | (3) | Inside transmission antenna assembly (Rear) <Vehicles with KOS> | F-18 | (2-GR) | License plate light (LH) |
| F-03 | (1-B) | Rear window defogger (-) | F-19 | (3) | Trunk lid latch |
| F-04 | (2-B) | Curtain air bag module (squib) (RH) | F-20 | (3-GR) | Outside transmission antenna assembly (Trunk lid) <Vehicles with KOS> |
| F-05 | (2-GR) | High-mounted stoplight | F-21 | (2-GR) | Outer tone alarm <Vehicles with KOS> |
| F-06 | (4) | Rear combination light (RH) | F-22 | (3-GR) | Backup light (LH) |
| F-07 | (2-GR) | Rear side marker light (RH) | F-23 | (2-GR) | Evaporative emission ventilation solenoid |
| F-08 | (3-GR) | Backup light (RH) | F-24 | (2-GR) | Rear side marker light (LH) |
| F-09 | (2) | Trunk lid opener switch <Vehicles with KOS> | F-25 | (4) | Rear combination light (LH) |
| F-10 | (2-B) | Direction valve (LH) | F-26 | (4-B) | Sub woofer <Vehicles with audio amplifier> |
| F-11 | (4-GR) | Rear floor wiring harness (RH) and AYC sub wiring harness combination | F-27 | (10) | Rear floor wiring harness (LH) and trunk lid wiring harness combination |
| F-12 | (2-B) | Direction valve (RH) | F-28 | (2-B) | Curtain air bag module (squib) (LH) |
| F-13 | (3-B) | Pressure sensor | F-29 | (1-B) | Rear window defogger (+) |
| F-14 | (2-GR) | Electric pump | | | |
| F-15 | (2-GR) | License plate light (RH) | | | |
| F-16 | (3-B) | Proportioning valve (for ACD control) | | | |